

1) Specifications

Casing diameter 15.15mm x 13.00mm
 Height 3.66mm
 Vibrations per hour 21,600 (6 beats per second)

2) Features

The 1100 is a new calibre designed to offer excellent time accuracy and stability over a long period as a lady's wrist watch. The movement is based on the 1104, and the principal features are as follows:

1. The stability of the movement is raised by increasing the moment of inertia of the balance to an extent incomparable with any other movements of this class.
2. The escapement is designed small and lightweight to minimize watch gain or loss due to escapement errors.
3. The train wheel is designed large enough to the space limit to minimize difference of watch posture when it is worn on the wrist.

3) Disassembly and assembly

Disassemble the watch according to Figs. (1) - (37).

Assemble by reversing the above order: Figs. (37) - (1)

4) Lubrication

Colored symbols in the illustrated figures indicate the types of oil, its quantities to be applied, and the lubricating points.

Types of oil

- ▶ Moebius Synt-A-Lube
- ▶ Seiko Watch Oil S-4

Oil quantity

- ▶ Sufficient quantity
- ▶ Normal quantity
- ▶ Extremely small quantity

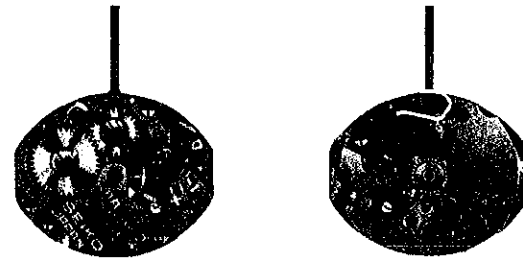

Movement

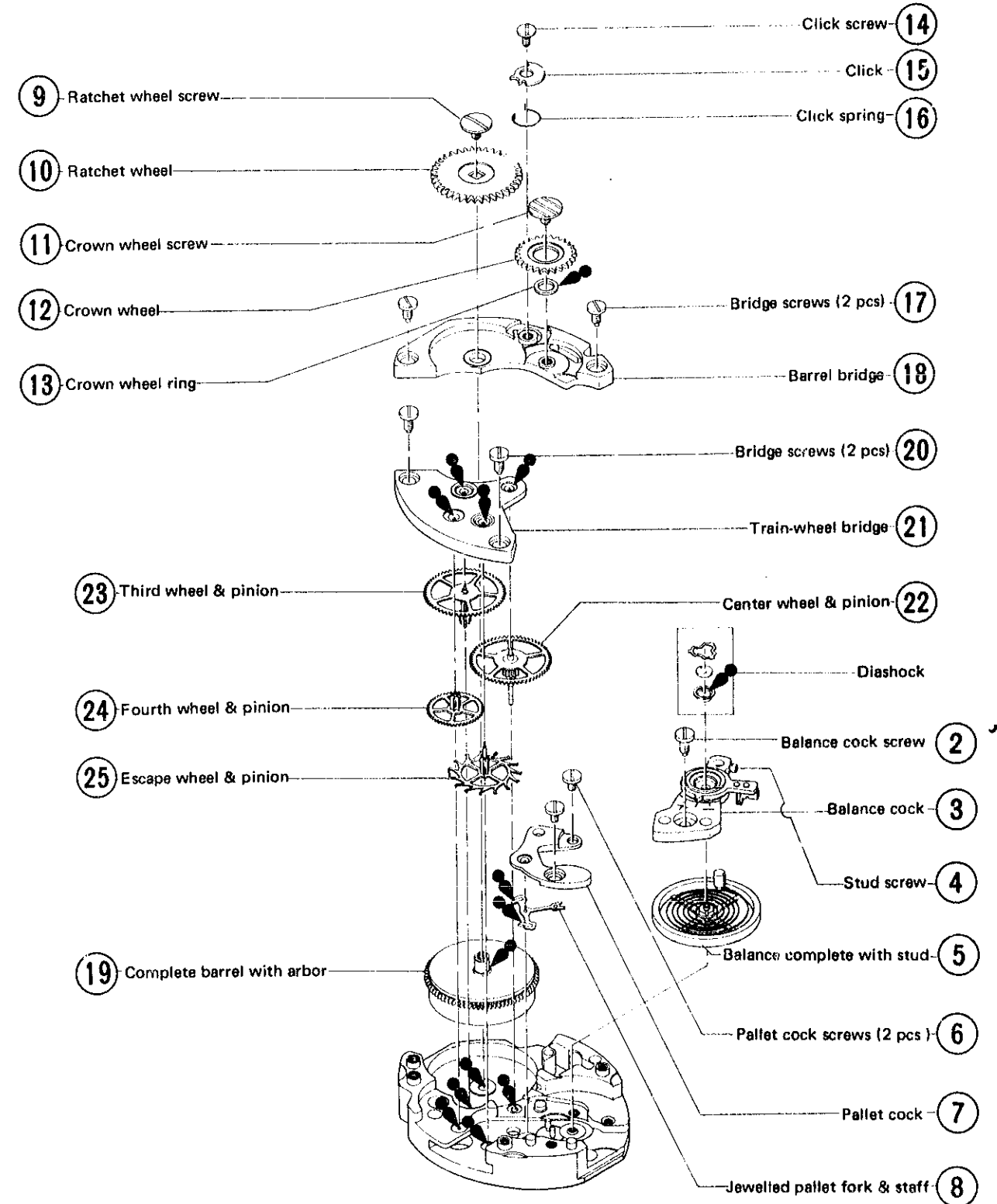

1100A Setting Mechanism

